

FAIRFAX/LOUDOUN PROPANE

A DIVISION OF DECARLO ENTERPRISES

9754 LEE HIGHWAY, FAIRFAX, VA 22031

(703)352-5777

FAX (703)352-8131

Dear New Customer,

Enclosed is your propane delivery agreement. If you use propane for any of the following items you have the option to be on our "automatic delivery" program. The delivery frequency is by the average temperature each day; deliveries will then be scheduled when we are in the area.

- furnace/back up furnace

You may choose this option by checking the **3rd box** down in the propane delivery category.

If you use propane for any of the following items then you have the option of having deliveries made in certain time increments.

- cooking or cook top (100 gallon capacity cylinder is approximately 180 days, 48 gallon capacity is approximately 90 days.)
- water heater (recommended time frame is every 60 – 90 days)
- dryer (recommended time frame is every 60 – 90 days)

You may choose this option by checking the **4th box** down in the propane delivery section.

If you use the propane for any of the following items:

- gas logs
- pool/spa heater
- gas light
- space heater, etc

You will need to call-in your fills. This is the **5th box** down in the propane delivery section. If possible please call your fills in when the gauge reads between 20% - 30%. During peak season delivery may take 3-4 days.

The driver will not schedule appointments and it is very difficult to have him call before delivery. We do not have a daily schedule for the drivers but we do dispatch the orders as soon as we receive them. It will help us to expedite your order if you have all of your information (tank size and percentage) when you place the order.

Thank you for your cooperation, please fill in the form (a daytime phone number is very helpful), sign and send the white copy back as soon as possible.

Sincerely,



Linda G. Griffith

Fairfax/Loudoun Propane

FAIRFAX/LOUDOUN PROPANE

A DIVISION OF DECARLO ENTERPRISES

9754 LEE HIGHWAY, FAIRFAX, VA 22031

(703)352-5777 FAX (703)352-8131

Dear New Customer,

Welcome to ***Fairfax Propane!*** We are excited about servicing you in any way we can. We dispatch your order to our drivers as soon as we receive it. Serving you as quickly as possible is our goal. Your order will normally be delivered within 48 hours of dispatch, depending on demand and weather conditions. It is helpful if you have your tank size and remaining percentage when you call. Our drivers are friendly and courteous and welcome any suggestions you might have. If you would like, we can set up an account for you and also arrange for automatic delivery. Just call and let us know.

For future reference, we sell grills and stock most grill parts. We do in shop and also home repair service for most types of grills. Some of ***Fairfax Propane's*** other services include installation of gas log fireplaces (what a ***ROMANTIC*** way to supplement your chilly heat pump this winter!) We can even convert your present heating system to propane gas, whether you're in a house, patio home or townhouse. ***Fairfax Propane*** also installs cylinders/tanks for pool and spa heaters. We are glad to be of service in any way possible.

Sincerely,

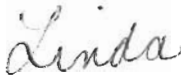

Linda G. Griffith

Fairfax/Loudoun Propane

Fairfax Loudoun **PROPANE**

"Your Hometown Propane Company"

9754 Lee Highway, Fairfax, VA 22031 Phone (703) 352-5777 Fax (703) 352-8131

Propane Tank Installation Proposal / Agreement

Consumer: (Person / Organization responsible for payments)

Name Tim Ridley

Street 9011 Georgetown Pike

City, State Great Falls, VA Zip Code 22066

Phone (H) (703) 757-9677 (W) (F) (703) 547-1514

Work to be performed at: (Same as consumer if blank)

Name Remold Remodeling existing home

Street _____

City, State _____ Zip Code _____

Directions INSTALLATION TRUCK & TRAILER MUST PULL IN DWY & BACK OUT ONTO ROAD OR OPPOSITE

Map D3912 Building Permit _____

This installation includes: (Check all that apply)

Propane storage vessel qty 1 size 1000 gallon

Above ground Under ground

Tank will be owned by: Fairfax Propane Customer

50 feet of gas piping from TANK TO outside wall of garage only.

1/2" O.D. Tubing - 500,000 BTU MAX

Black Steel Yellow painted copper Plastic piping

Regulators: Qty: 2

1st stage 2nd stage Dual stage _____

Sleeving _____ feet

Connect gas line to tank & house piping

Install _____ shut off valves

Install & assemble _____ customer provided gas logs.

Contact Miss Utility

Tank excavation. Set tank with: bobcat Crane

Trenching 30 feet

Hand digging 15 feet under walk to garage

Tracer wire, warning tape.

Cathodic anodes for under ground tank 1-17#

Permit fees, processing, inspections, sales tax.

Concrete: slabs curbs existing

Deduct \$350.00 if excavation, trench, backfill is by others.

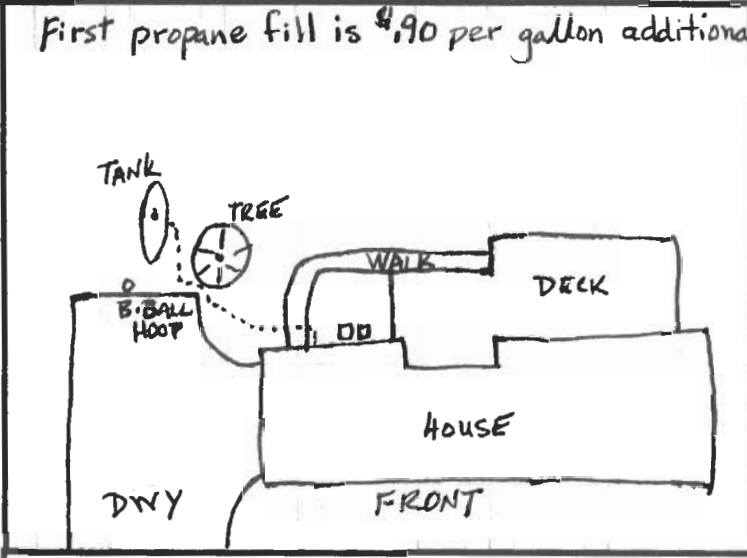

Propane Delivery (Check all that apply)

Annual minimum propane purchase of _____ gallons.

Annual prorated rental \$ _____ if minimum is not met.
Annual minimum & rental year starts November 1 each year, first year is prorated to installation date.

First propane fill is additional, the price of propane will fluctuate.

The current price of propane is \$ _____ per gallon.

This container(s) may be purchased for \$ _____ additional with no minimum or rental, current price \$ _____ per gallon.

- Exclusions, Exceptions and Extras:**
- Consumer accepts full responsibility for damage to under ground wires, pipes and or other obstructions.
 - Excavation in rock may require specialized equipment and additional labor both of which will be additional.
 - Customer must provide sand or clean fill when necessary to protect tank or piping from rocky conditions.
 - Customer provided excavation must meet code requirements and allow for proper installation of tank or piping.
 - Repair or replacement of landscape materials and or plants to include grass is not included or available.
 - Appliances and propane appliance conversions are not included.
 - Permit fees and processing costs are additional if not specifically included in this proposal.
 - Repairs or damages caused by malfunctioning appliances installed according to manufactures instructions.

- (Check all that apply)**
- Customer will pay permit fees.
- Excavation, trench, backfill is not included.
- A copy of site plan or plat is required.
- Existing septic or well on property.
- Virginia Easement Agreement is required for Fairfax Propane owned under ground tanks.
- Flagged tank and piping location.
- _____

We Propose hereby to furnish the materials and labor in accordance with these specifications for the sum of \$ 2047.02

Payable as follows: Deposit (Required to start work) \$ 1023.51 Balance due upon completion \$ 1023.51

Balances over 30 days late will be charged up to 18% APR (1.5% per month) plus collection costs and attorney's fees of one third (1/3) of any amounts due or \$500.00 whichever is greater.

Submitted by: LINDA GRIFFITH Date: 5-12-99 This proposal may be withdrawn if not accepted within 30 days.

Acceptance of Proposal: The above and reverse prices, specifications and conditions are satisfactory and are hereby accepted. You are authorized to do the work as specified. Payments will be made as outlined above.

Signature: _____ Date _____

FAIRFAX PROPANE

A Division of DeCarlo Enterprises, Inc.

9754 Lee Highway, Fairfax, VA 22031 Phone (703) 352-5777 Fax (703) 352-8131

Service Invoice

Nº 005187

Consumer:		Work performed at: <small>(Same as consumer if blank)</small>	
Name <u>TIM RIDLEY</u>	Street <u>9011 RT 193</u>	Name _____	Street _____
City, State, Zip <u>GF VA</u>	Phone (H) _____ (W) _____	City, State, Zip _____	Phone (H) _____ (W) _____

Date 9/2/99 Terms: COD On Account No Charge

QTY	MATERIAL	PRICE	AMOUNT
1	MULTI BOUNSET ASSEMBLY		N/A
(TANK # 14430)			

Press. Test	START PRESS	END PRESS	TIME HELD	OK	LABOR	HRS	RATE	AMOUNT
Single Stage					<u>Day</u>			
Two Stage	8.0"	80"uc	10MIN	(OK)				

COMMENTS:

- REPLACED TANK SERVICE VALVE
- LEAK TESTED TANK FITTINGS → (OK)
- Pressure tested piping system → (OK)
- STARTED FURNACE / WH → FURNACE IS TURNED "OFF" / WATER HTG. NOT INSTALLED YET
- (NOTE) THE GEN. SHOULD HAVE A SHUT OFF VALVE AND SEDIMENT TRAP INSTALLED @ GENERATOR.
- (NOTE) THE FURNACE MUST HAVE A MAXITROL REGULATOR INSTALLED

1st Stage Running	
1st Stage Lock Up	
2nd Stage Running	
2nd Stage Lock Up	
TOTAL LABOR	N/A
TOTAL PROPANE	
TOTAL MATERIALS	
SALES TAX 4.5%	
TOTAL	N/A

Payment Type: Cash \$ _____ Check # _____ Credit Card Number _____ Expiration _____

Acceptance: The above and reverse terms and conditions are satisfactory and are hereby accepted. Payments for propane and other services placed on account will be made with in thirty (30) days of the delivery. Balances over 30 days late will be charged 18% APR (1.5% per month) plus collection costs including reasonable attorney's fees of one third (1/3) of any sums due or \$500.00 whichever is greater.

Consumer Signature: [Signature]

Date _____

MAIN LEVEL
 9011 GEORGETOWN PIKE
 GREAT FALLS, VIRGINIA
 All information is believed to be accurate, but is not guaranteed.
 © 1998 / Daniel Veris
 All rights reserved.

Handwritten: 5/3/99

Handwritten: Exhibit A

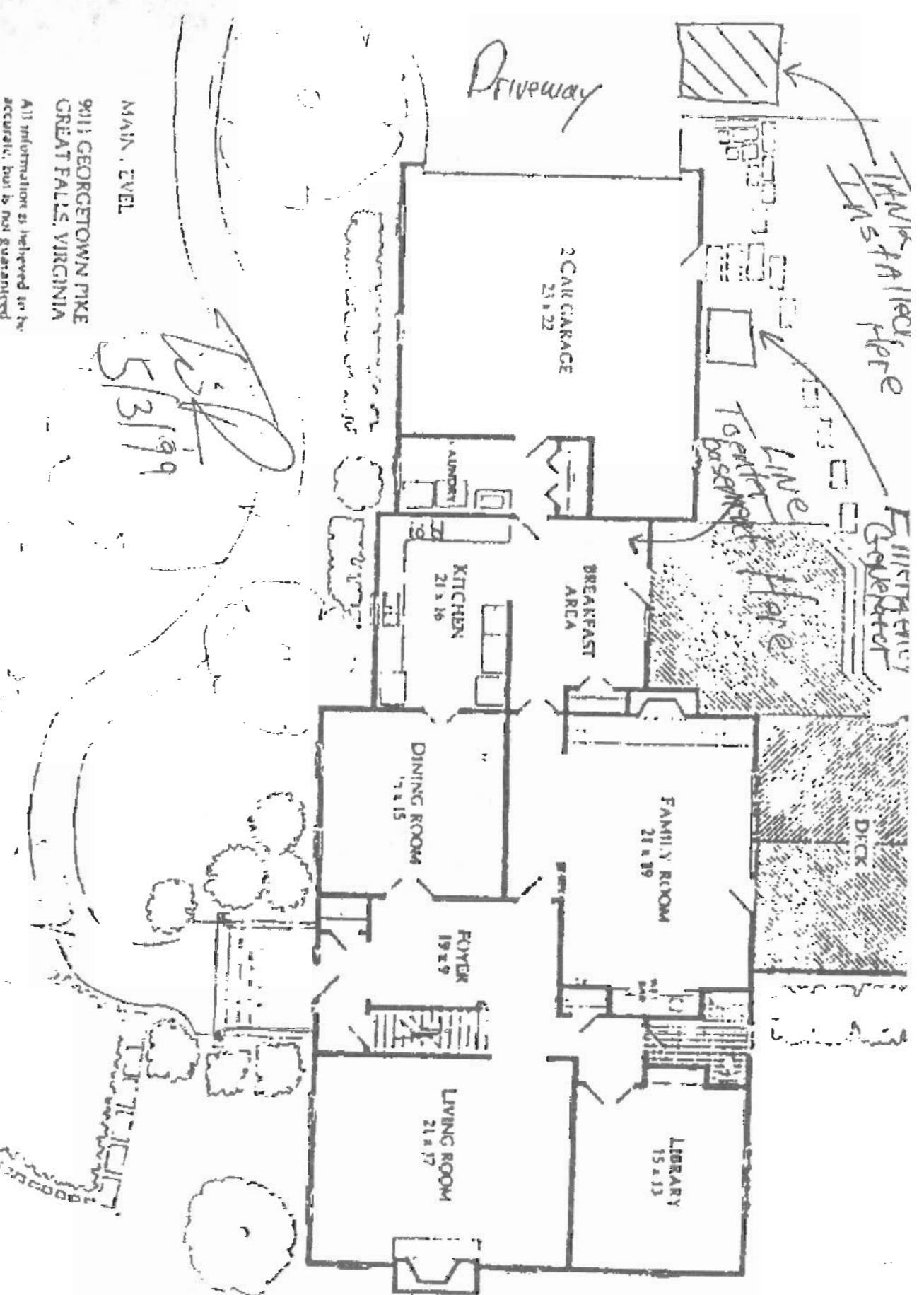

Fairfax Propane

#839

Invoice

9754 Lee Highway
Fairfax, Virginia 22031
Phone: 703-352-5777
Fax: 703-352-8131

Date
Jul 13 1999

Page
1

Invoice Number
IN0000000056925

Sold To: RIDLEY, TIMOTHY
9011 GEORGETOWN PIKE
GREAT FALLS, VA 22066

Ship To: RIDLEY, TIMOTHY
9011 GEORGETOWN PIKE
GREAT FALLS, VA 22066

Order No. ORD000000060000	Order Date Jul 13 1999	Customer No. 4744	Salesperson	PO Number	Ship Via	Terms B
------------------------------	---------------------------	----------------------	-------------	-----------	----------	------------

Qty. Ord.	Qty. Shp.	Qty. B/O	Item Number	Description	Unit Price	UCM	Extended Price
1.000	1.000	0.000	111111TITKSU1000	1000 GALLON UNDER GROUND TANK	1,549.00	EA	1,549.00
1.000	1.000	0.000	1111111TNPRIINST	PERMITS-INSTALLATION	78.31	EA	78.31
1.000	1.000	0.000	11111111TLLAIPKG	INSTALLATION LABOR	350.00	HR	350.00
Date Due				Amount Due	Disc. Date	Disc. Amount	
Aug 12 1999				2,047.02	Jul 13 1999	0.00	

Comments:

Tax summary:

OE0001 69.71
OE0002 0.00
OE0003 0.00
OE0004 0.00

Subtotal	1,977.31
Total sales tax	69.71
Total amount	2,047.02
Less payment	0.00
Less pmt. disc.	0.00

Amount due
2,047.02

Balance due 1023.51

Wacker



PLUMBING

19484 Youngs Cliff Road • Sterling, Virginia 20165
(703) 450-5565 • (703) 444-1413 • Fax (703) 444-3234

Work Order

DATE: 11/2/1999 INVOICE #: 3656

*Paid in full
935*

BILL TO:

**Tim Ridley
9011 Georgetown Pike
Great Falls, VA 22066**

PHONE #	REP	P.O. NUMBER	TERMS	PROJECT
757-9677	LWH	3-5	C.O.D.	

QUANTITY	DESCRIPTION	RATE	AMOUNT
----------	-------------	------	--------

Hook up owner supplied propane cook

*hooked up o/s Propane 1 hr
Cook Top 1 Flex Eng gas
Conn*

TIME IN: TIME OUT:

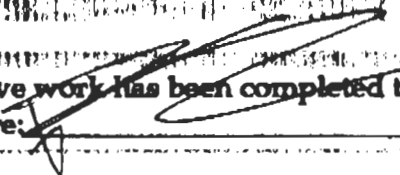
The above work has been completed to my satisfaction.
Signature: 

TOTAL \$124.00



21595 CEDAR LANE, UNIT A
STERLING, VA 20166
Phone: (703) 404-4867 / Fax: (703) 404-8340

PLUMBING

Work Order/Invoice

43573

B _____ H. PHONE _____ DATE: 3/27/00
 L _____ W. PHONE _____ NAME: _____
 L _____ REQUESTED BY _____ LOCATION: Full House Remodel
 T _____ MGMT. CO. _____ St. Falls, Va
 O _____ P.O. # _____

SPECIAL INSTRUCTIONS

- COMPLETE
- INCOMPLETE
- PARTS TO ORDER
- WARRANTY / CALL BACK

DESCRIPTION OF WORK	QTY	CODE	INVENTORY	PARTS DESCRIPTION	TOTAL
Put installed in place	4			1/2" x 1/2" x 1/2"	11.70
and has separate lines	1			1/2" x 1/2" x 1/2"	11.40
for slow moving	5			1/2" x 1/2" x 1/2"	22.88
total	2			1/2" x 1/2" x 1/2"	3.00
	7			1/2" x 1/2" x 1/2"	1.00
	4			1/2" x 1/2" x 1/2"	1.00
	4			1/2" x 1/2" x 1/2"	1.00
	10			1/2" x 1/2" x 1/2"	1.00
	41			1/2" x 1/2" x 1/2"	1.00
					5.00

SERVICE REP	DEPART TIME	START TIME	STOP TIME	TOTAL HOURS
<u>David</u>		9:45	5:5	

TOTAL MATERIALS 132.24
 TOTAL LABOR 330.00
 OTHER _____
 TOTAL 462.24
 AMOUNT PAID 160.00

CREDIT CARD CHECK CASH CARD # 1558

EXPIRATION DATE _____ NAME _____

BILLING AUTHORIZATION BY _____

I HEREBY ACKNOWLEDGE THE SATISFACTORY COMPLETION OF THE ABOVE DESCRIBED WORK

SIGNATURE _____

DATE 3/27/00

Thank You!

WARRANTY

WARRANTY: 30 days Parts/Labor on our work, from date of completion. This warranty is void if any part of this installation is adjusted or altered by anyone other than ourselves.

The following items are not covered on warranty: Sewer Stoppage, Sink Stoppers, Water Service Repairs, unless under a contract with us. This warranty is void if purchaser fails to pay in full for services.

Fairfax Loudoun PROpane

"Your Hometown Propane Company"

9764 Lee Highway, Fairfax, VA 22031 Phone (703) 352-5777 Fax (703) 352-8131

Propane Tank Installation Proposal / Agreement

Consumer (Person / Organization responsible for payments)
 Name Tim Ridley
 Street 9011 Georgetown Pike
 City, State Great Falls, VA Zip Code 22066
 Phone (703) 757-9677 (w) (703) 513-1514

Work to be performed at: (Same as consumer if blank)
 Name Remodel Remodeling existing home
 Street _____
 City, State _____ Zip Code _____
 Directions INSTALLATION TRUCK & TRAILER MUST PULL IN DWY & BACK OUT ONTO ROAD OR OPPOSITE
 Map Q3912 Building Permit

- This installation includes: (Check all that apply)**
- Propane storage vessel qty 1 size 1000 gallon
 - Above ground
 - Under ground
 - Tank will be owned by: Fairfax Propane Customer
 - 50 feet of gas piping from TANK TO outside wall of garage only.
 - 1 1/2" O.D. Tubing - 500,000 BTU MAX
 - Black Steel
 - Yellow painted copper
 - Plastic piping
 - Regulators: Qty: 2
 - 1st stage
 - 2nd stage
 - Dual stage
 - _____
 - Sleeving _____ feet
 - Connect gas line to tank & house piping
 - Install _____ shut off valves
 - Install & assemble _____ customer provided gas logs.
 - Contact Miss Utility
 - Tank excavation. Set tank with bobcat crane
 - Trenching 30 feet
 - Hand digging 15 feet under walk to garage
 - Tracer wire, warning tape.
 - Cathodic anodes for under ground tank 1-17#
 - Permit fees, processing, inspections, sales tax.
 - Concrete: slabs curbs existing
 - Deduct \$350.00 if excavation; trench, backfill is by others.
 - _____
 - _____

First propane fill is \$4.90 per gallon additional

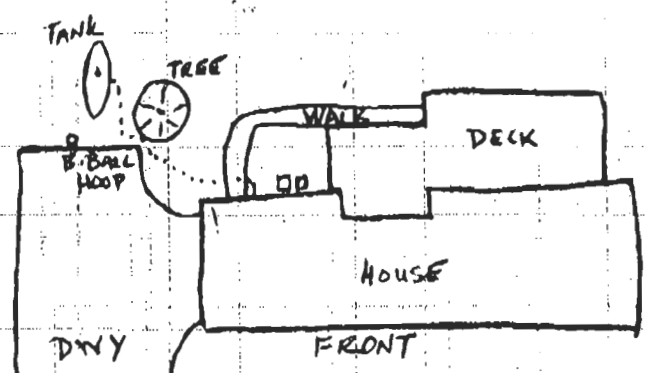

- Propane Delivery (Check all that apply)**
- Annual minimum propane purchase of _____ gallons.
 - Annual prorated rental \$ _____ if minimum is not met.
 Annual minimum & rental year starts November 1 each year, first year is prorated to installation date.
 - First propane fill is additional, the price of propane will fluctuate.
 - The current price of propane is \$ _____ per gallon.
 - This container(s) may be purchased for \$ _____ additional with no minimum or rental, current price \$ _____ per gallon.

- Exclusions, Exceptions and Extras:**
- Consumer accepts full responsibility for damage to under ground wires, pipes and or other obstructions.
 - Excavation in rock may require specialized equipment and additional labor both of which will be additional.
 - Customer must provide sand or clean fill when necessary to protect tank or piping from rocky conditions.
 - Customer provided excavation must meet code requirements and allow for proper installation of tank or piping.
 - Repair or replacement of landscape materials and or plants to include grass is not included or available.
 - Appliances and propane appliance conversions are not included.
 - Permit fees and processing costs are additional if not specifically included in this proposal.
 - Repairs or damages caused by malfunctioning appliances installed according to manufacturers instructions.

- (Check all that apply)**
- Customer will pay permit fees.
 - Excavation, trench, backfill is not included.
 - A copy of site plan or plat is required.
 - Existing septic or well on property.
 - Virginia Easement Agreement is required for Fairfax Propane owned under ground tanks.
 - Flagged tank and piping location.
 - _____

We Propose hereby to furnish the materials and labor in accordance with these specifications for the sum of \$ 2047.02
 Payable as follows: Deposit (Required to start work) \$ 1023.51 Balance due upon completion \$ 1023.51
 Balances over 30 days late will be charged up to 18% APR (1.6% per month) plus collection costs and attorney's fees of one third (1/3) of any amounts due or \$500.00 whichever is greater.

Submitted by: LINDA GRIFFITH Date: 5-12-99 This proposal may be withdrawn if not accepted within 30 days.

Acceptance of Proposal: The above and reverse prices, specifications and conditions are satisfactory and are hereby accepted. You are authorized to do the work as specified. Payments will be made as outlined above.

Signature: _____ Date: _____